

NASH 1, 2, & 3 LIGHT FLUSH MOUNTS

75435; 75436; 75434; 75446

General Product Information

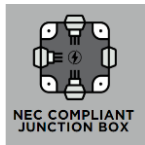
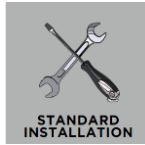

Suggested/Required Tools



Safety Information

CAUTION-RISK OF FIRE

This product must be installed in accordance with the applicable installation code by a person familiar with the construction and operation of the product and the hazards involved.

USE MINIMUM 90°C SUPPLY CONDUCTORS.



Turn off electrical current at the source before working with any lighting fixture or portable lamp.

Install and use this product in adherence with local electrical codes and regulations.



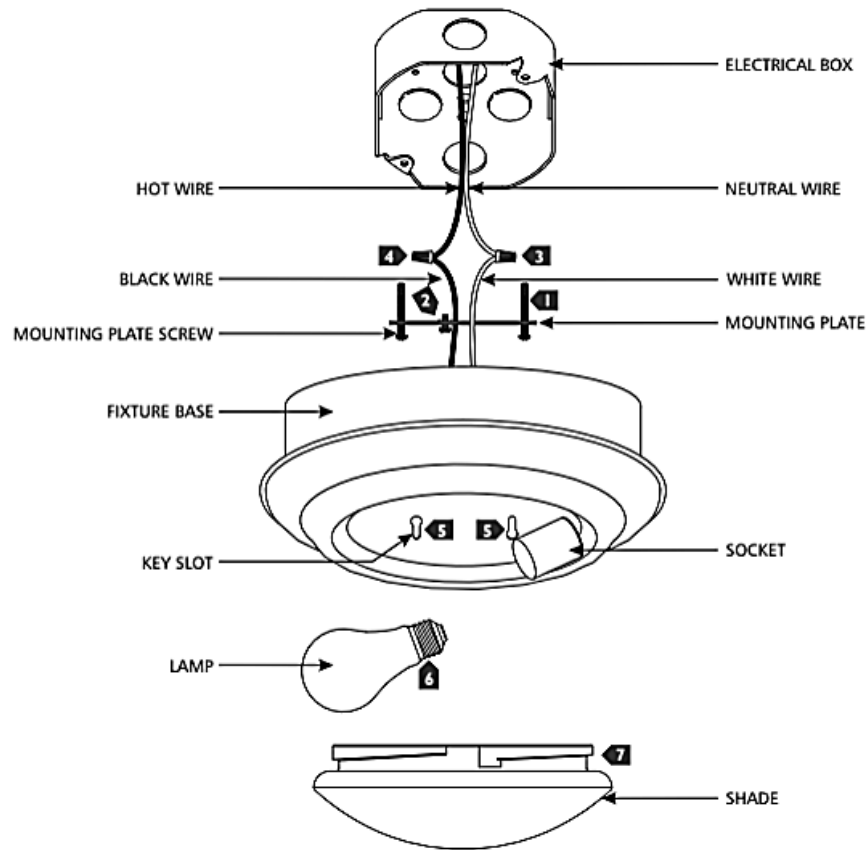

INSTRUCTIONS

I. Preparing the Fixture

1. Secure the mounting plate to the junction box with two mounting screws.

II. Wiring the Fixture

1. Safety first! Locate the circuit breaker and switch it off to cut off the power supply to the relevant circuits to ensure there's no electricity running through the wiring.
2. In accordance with local electrical codes, connect the fixture ground wire (bare copper or silver wire) to suitable ground. This may be a green ground screw on the mounting plate, which the ground wire should be tightly wrapped around or a house wire (green or bare copper wire without insulation).
3. Twist the bare ends of the following pairs of wires together using a wire nut to secure a connection:
 - a) Hot fixture wire to hot power line wire
 - b) Neutral fixture wire to neutral power line wire
4. Carefully tuck all the wires into the junction box.

III. Installing the Fixture

1. Align the key slots on the fixture base to the mounting plate screws, place the fixture base onto the mounting plate, and secure by rotating it to the narrow portion of the keyed slots.
2. Screw the lamp(s) into the socket(s). Refer to the label on the socket for max wattage information.
3. Install the glass shade by lining it up with the fixture and turning it to lock it in place.